

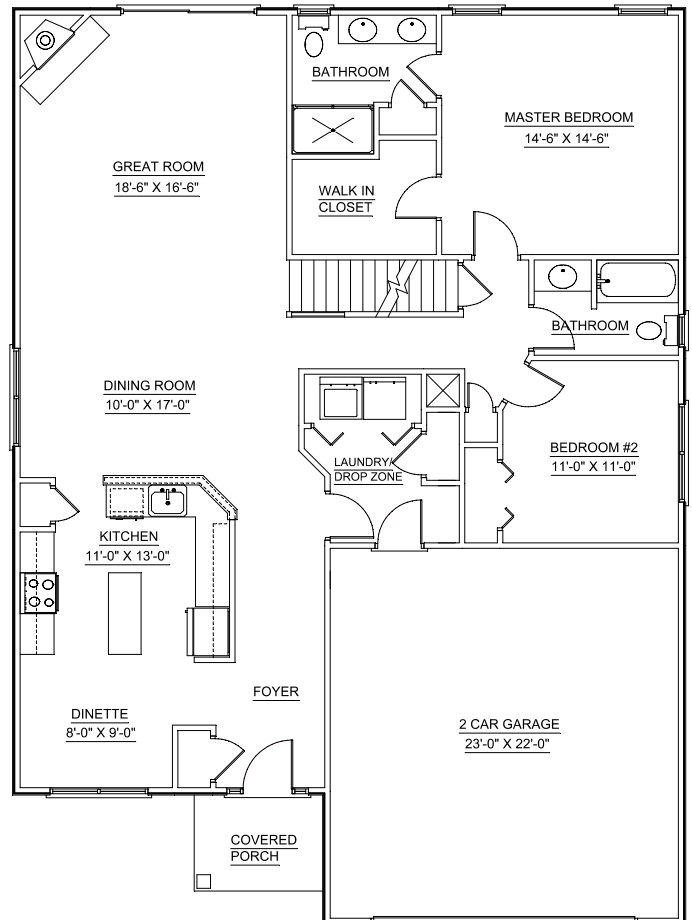

WHITE BIRCH

TRADITIONAL ELEVATION 2,050 sq. ft.

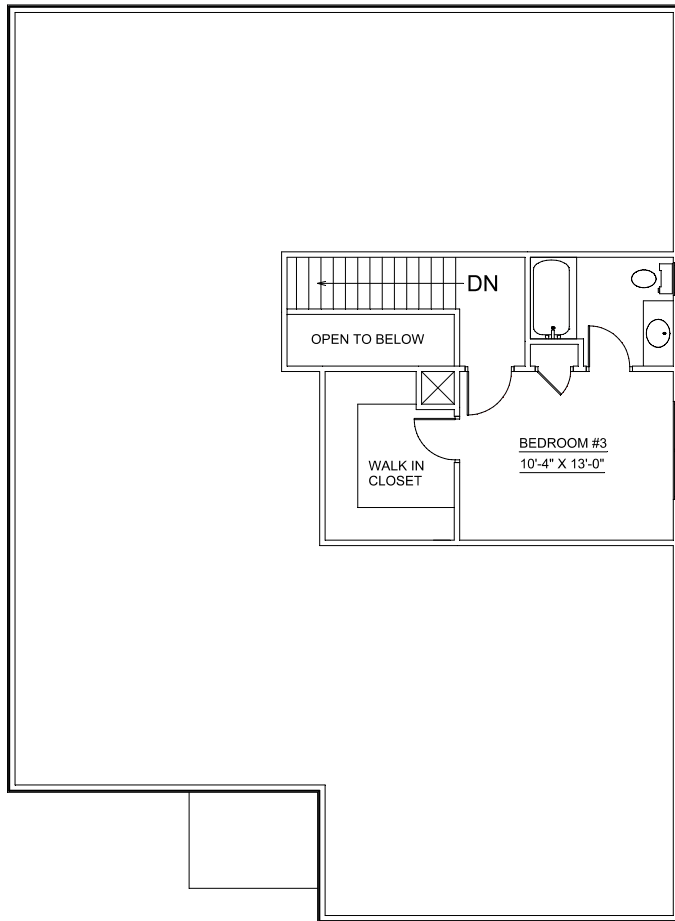

The rendering and floor plans represent the model depicted. Room dimensions are approximate and may vary according to the field conditions. Builder reserves the right to alter dimensions and may substitute any item specified with a brand of equivalent quality provided the financial and structural integrity of the building is not compromised. The specification sheet supersedes all artistic renderings. All specifications are subject to change and the Builder reserves the right to make modifications or changes without notice or obligation. All building plans may be reversed (mirror image) from what was depicted on the artistic rendering elevations or the site plan map.



WHITE BIRCH

CRAFTSMAN ELEVATION 2,050 sq. ft.

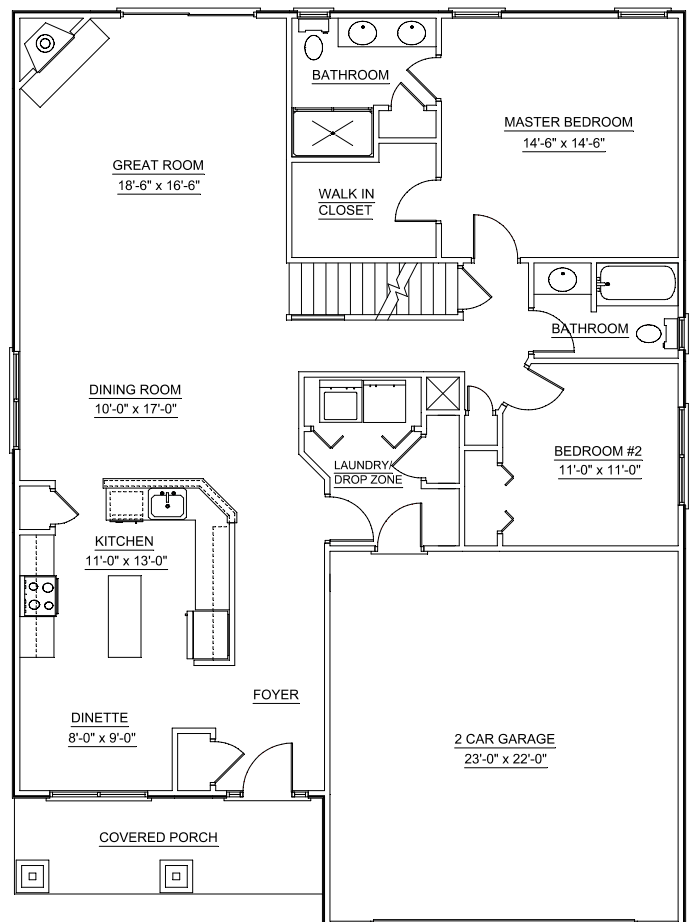
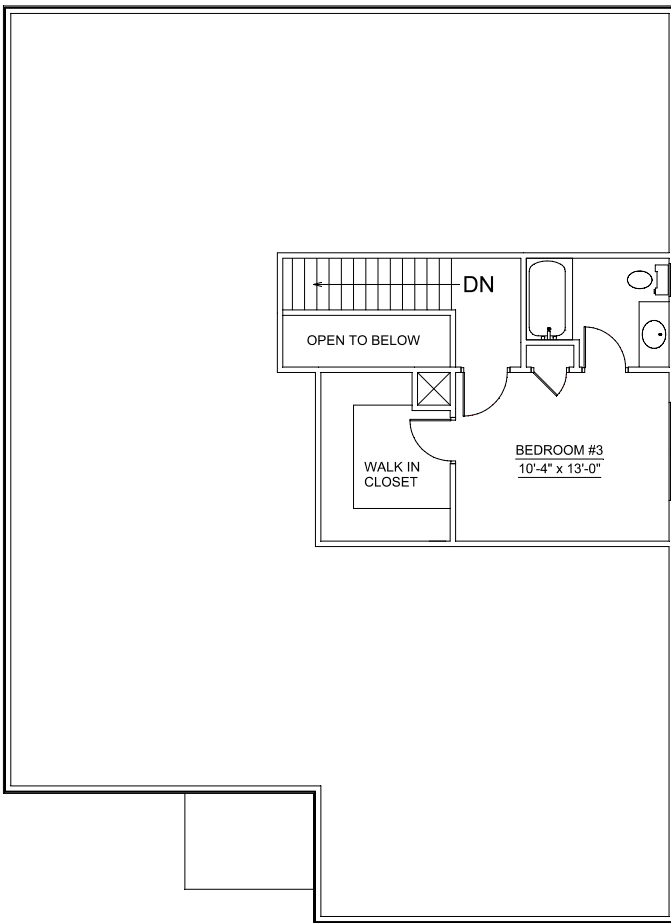

The rendering and floor plans represent the model depicted. Room dimensions are approximate and may vary according to the field conditions. Builder reserves the right to alter dimensions and may substitute any item specified with a brand of equivalent quality provided the financial and structural integrity of the building is not compromised. The specification sheet supersedes all artistic renderings. All specifications are subject to change and the Builder reserves the right to make modifications or changes without notice or obligation. All building plans may be reversed (mirror image) from what was depicted on the artistic rendering elevations or the site plan map.